

=====

QUOTE INFORMATION:

=====

Quote Id:

Purchaser:

Project: Storage/Shop

Customer Info:

Plattsmouth, NE

=====

=====

SteelBuildingSupplier.com

225 S Academy Blvd Ste 201

Colorado Springs CO 80910

800.793.8555

Contact: Steve Carter

=====

Quote good for 7 days

=====

BUILDING TYPE

=====

Commercial Rigid Frame Steel

=====

=====

PRICING

=====

Building Components \$

Subtotal \$

Building Freight \$

Detail/Draft Fee \$

Stamped Plan Sets (1) \$

TOTAL COST \$

=====

BUILDING LOCATION

=====

Plattsmouth, NE

=====

=====

BUILDING DESIGN SPECIFICATIONS

=====

----- Dimensions -----	----- Loading -----
Width(ft): 50	Wind Code: IBC 00 Exposure: C
Length(ft): 80	Wind (mph): 90 Importance: 1.00
Back eave height(ft): 14	Roof Live Load (psf): 20
Front eave height(ft): 14	Roof Dead Load (psf): 2
Back roof slope: 2.0:12	Roof Snow Load (psf): 30
Front roof slope: 2.0:12	Roof Collateral Load (psf): 1
	Seismic: -

Engineering:

Stamped Plan Sets: 1

Design Calc Sets: none

Covering:

Roof: 26 Gauge, Classic Roof (PBR) Panels, Color: Burnished Slate SP

Sidewall: 26 Gauge, Reverse Classic Panels, Color: Polar White SP

Endwall: 26 Gauge, Reverse Classic Panels, Color: Polar White SP

Sidewall trim at eave : Burnished Slate SP

Endwall (rake) trim at roof : Burnished Slate SP

Outside jamb sheeting trim color: Polar White SP

Outside corner trim color : Polar White SP

Framing:

----- Interior -----

3 rigid frames, clear span

Frame Design Id Column Type Rafter Type



1 tapered depth tapered depth

Spacing along front sidewall: 4 at 20

----- Exterior Walls-----

Endwall: Left = Bearing, Flush girts
Right = Bearing, Flush girts

Sidewall: Front = Flush
Back = Flush

----- Wind -----

Roof: Cable Diagonal Bracing
Endwall: Left = Cable Diagonal Bracing
Right = Cable Diagonal Bracing
Sidewall: Front = Cable Diagonal Bracing
Back = Cable Diagonal Bracing

Factory Located Framed Openings:

Left Endwall : none
Front Sidewall : (3) 12 W x 12 H
Right Endwall : none
Back Sidewall : none

Gutters and Downspouts:

Front sidewall gutters(ft): 80 Color: Burnished Slate SP
Front sidewall downspouts: 3 Color: Polar White SP
Back sidewall gutters(ft): 80 Color: Burnished Slate SP
Back sidewall downspouts: 3 Color: Polar White SP

=====
ACCESSORY ITEMS
=====

Walk Doors: 1 - 3070FPW

2 RIDGE VENT 9"x10-0 White FlatSkirt, w/Scrn/Damper/

Translucent Wall Panels: none
Translucent Roof Panels: none

Liner Panels:

Left Endwall: none
Right Endwall: none
Front Sidewall: none
Back Sidewall: none

Insulation:

Roof: none
Wall: none

Delivered Weight: 22344.6 lbs

SPLICE BOLTS						
Splice Mark	Quan			-----Bolt-----		
	Top	Bot	Int	Type	Dia	Len
SP- 1	4	4	0	A325	0.750	2.75
SP- 2	4	4	0	A325	0.625	2.25

MEMBER SIZE TABLE (in)

▽ FLANGE BRACES: Both Sides (Unless Noted)
A - L2525105

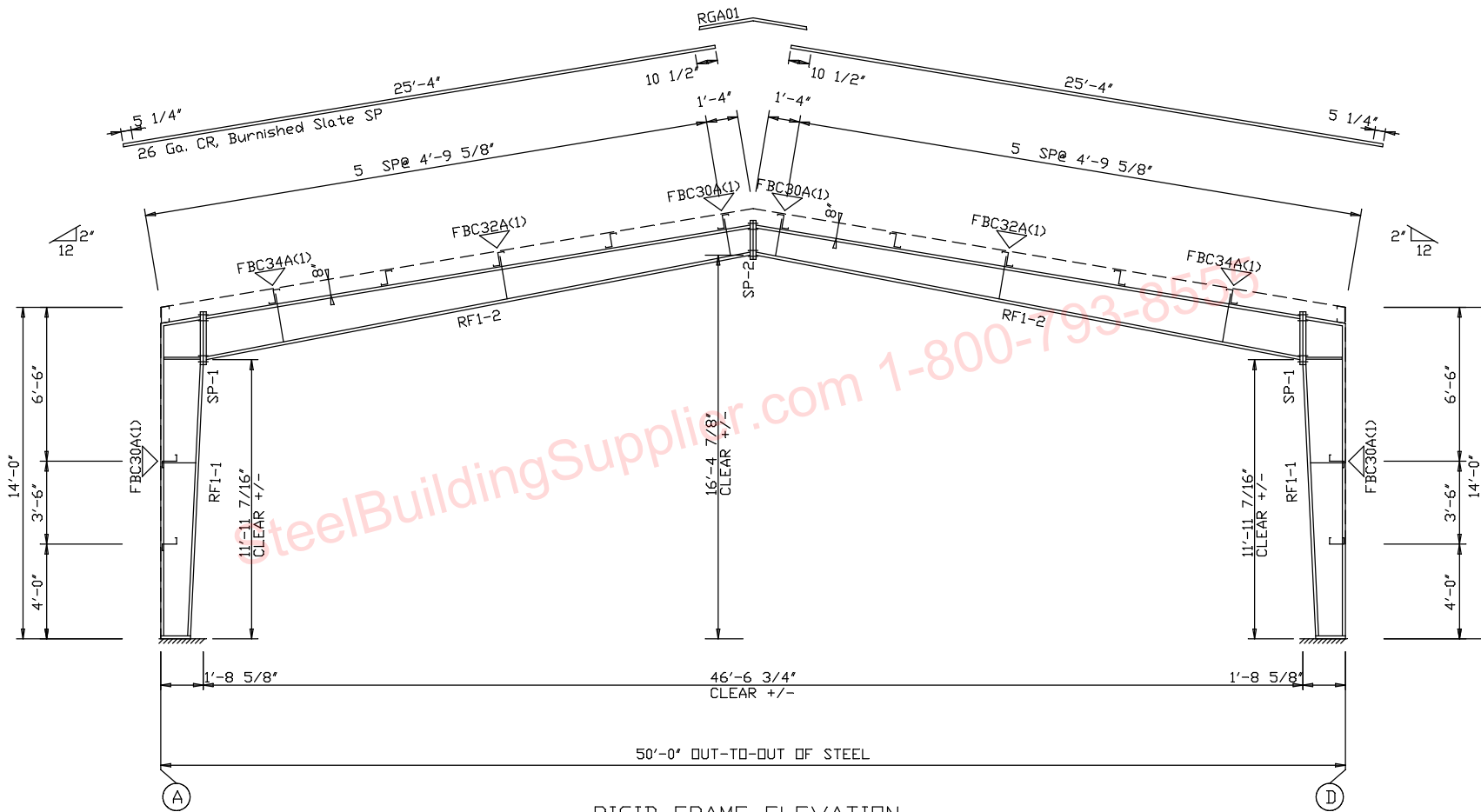

RIGID FRAME ELEVATION
FOR FRAME LINE 2 3 4

SteelBuildingSupplier.com		RIGID FRAME ELEVATION	
PROJECT	Storage/Shop	DESIGN: Steve	
ID		CHECK:	
PROJECT ADDRESS		DATE:	SHEET OF NBS

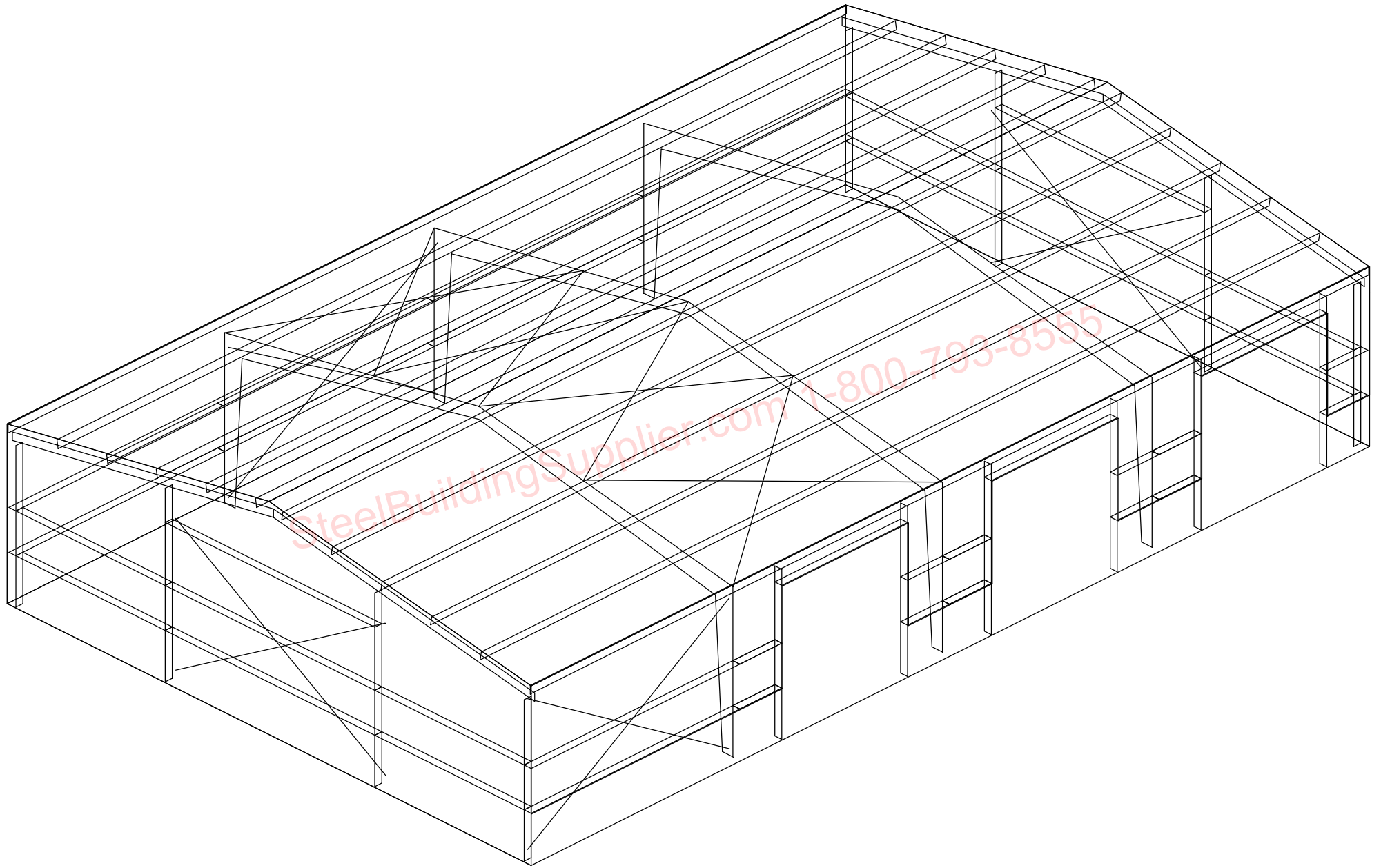

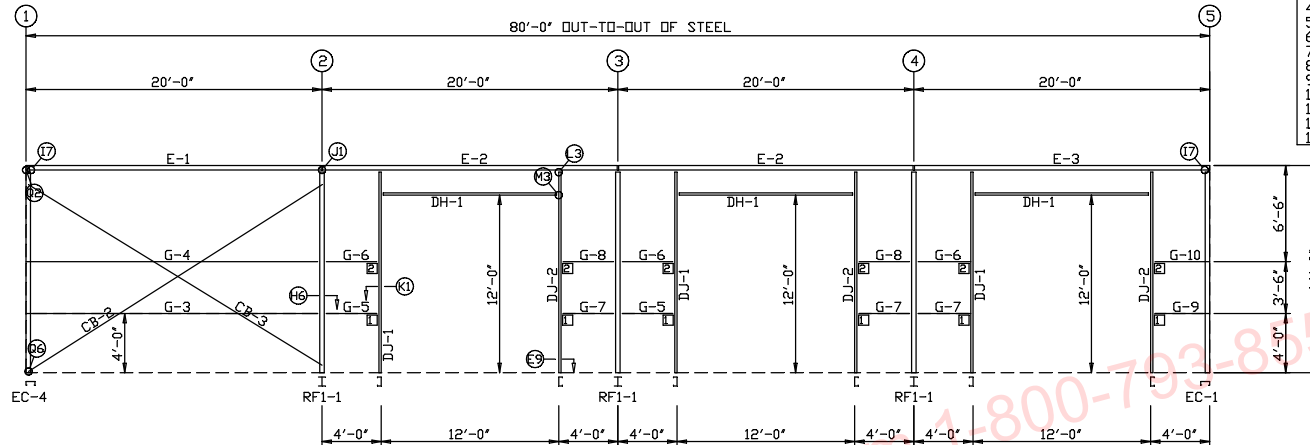

TRIM TABLE			
FRAME LINE D	ID	PART	LENGTH
	1	BSS01	10'-2"
	2	OCA01	20'-2"
	3	MFA01	10'-1"
	4	H4000	5'
	5	RCA01	9 1/4'
	6	GRA01	8'
	7	RCA02	9 1/4'
	8	GTA01	10'-1"
	9	GTA02	20'-2"
	10	LEA01	10'-2"
	11	CTA01	10'-1"
	12	JTD02	8'-1"
	13	HTA05	12'-2"

MEMBER TABLE			
FRAME LINE D	MARK	PART	LENGTH
	DJ-1	J08C060	13'-4"
	DJ-2	J08C060	13'-4"
	DH-1		
	E-1		
	E-2		
	E-3		
	G-1		
	G-2		
	G-3		
	G-4		
	G-5		
	G-6		
	G-7		
	G-8		
	G-9		
	G-10		
	CB-2	CAA-	14'-11"
	CB-3	CAA-	21'-4"

CONNECTION PLATES			
FRAME LINE D	ID	MARK/PART	
	1	01	
	2	JCA&P02	

SIDEWALL FRAMING: FRAME LINE D

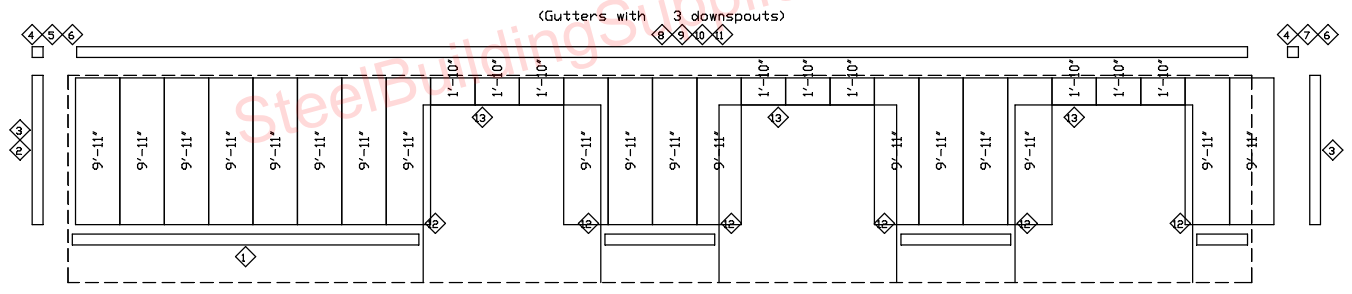

SIDEWALL SHEETING & TRIM: FRAME LINE D

PANELS: 26 Ga. RC - Polar White SP

SIDEWALL FRAMING PLAN: General Notes

- STANDARD ROD/CABLE SIZES PER PART PREFIX
- ROD/CABLE BRACING THAT OCCURS IN FLUSH OR INSET GIRT CONDITIONS WILL REQUIRE FIELD SLOTTING OF GIRT WEBS TO ALLOW FOR BRACING.
- FRAMED OPENINGS WHICH ARE FIELD LOCATED WILL REQUIRE FIELD CUTTING OF GIRTS AND SHEETING.
- THIS DRAWING IS NOT TO SCALE.

ROD	CABLE
RDB- = 5/8" ROD	CAA- = 1/4" CABLE
RDC- = 3/4" ROD	CAB- = 3/8" CABLE
RDD- = 7/8" ROD	CAC- = 1/2" CABLE
RDE- = 1" ROD	
RDF- = 1 1/8" ROD	
RDG- = 1 1/4" ROD	

SteelBuildingSupplier.com		SIDEWALL FRAMING	
PROJECT	Storage/Shop	DESIGN: Steve	
ID		CHECK:	NBS
PROJECT ADDRESS		DATE:	SHEET OF